

# Basement Floor Plan Proposed

Scale: 1:50

**Approved Document G: Sanitary Facilities Cold Water Supply:**  
The water supplied is to be wholesome (as defined in Approved Document G, 1.1 - 1.5), the pressure and flow rate is sufficient to supply all sanitary appliances within the building, is reliable and the installation conveys wholesome or softened wholesome water to the sanitary appliances and locations without waste, misuse, undue consumption or contamination of the water. The water is deemed wholesome in compliance with Approved Document G, 1.1

**Hot Water Supply:**  
Wholesome heated water must be supplied to any washbasin, bidet, fixed bath, shower and sink in any area where food is being prepared.  
The hot water system shall be designed, constructed and installed so as to resist the effects of temperature and pressure that may occur during normal use or in the event of a malfunction. The hot water system must be adequately supported.  
The hot water storage vessel must be supplied with a safety device to prevent any hot water stored exceeding a temperature of 100oC. Any discharge from installed safety devices should be safely conveyed to a point where it is visible but will not cause a danger to persons in or about the building.  
The hot water supply to any fixed bath must incorporate measures to prevent the water temperature from exceeding 48oC.

All in accordance with Approved Document G3.

**Sanitary Conveniences and Washing Facilities:**  
Adequate hand washing facilities must be provided in room containing sanitary conveniences or rooms or spaces adjacent to rooms containing sanitary conveniences. Any room containing a sanitary convenience, bidet or any facility for washing hands provided with a sanitary convenience must be separated from any kitchen or any area where food is prepared.

All in accordance with Approved Document G4.

**Internal Drainage:**  
100mm diameter soil and vent pipe with collection manifold in uPVC to terminate with vent a minimum of 900mm above any external opening within 3,000mm, or proprietary air admittance valve. 100mm diameter wastes to W.C's, 40mm diameter wastes to baths, sinks, washing machines and showers and 32mm diameter wastes to basins. All baths, showers and W.C's to be fitted with 50mm deep seal traps. All other appliances to be fitted with 75mm deep seal trap. Access plugs to be provided at all 90o changes in direction.

**Drains Under Buildings:**  
To be adequately protected, on bed and surround of granular material with linted opening to give 50mm clearance all round drains passing through or over footings. Voids around pipes to be filled with mineral fibre and cloaked both sides with rigid sheet material to prevent ingress of backfill and vermin. All in accordance with local Water Authority details and specifications.

**Special Protection:**  
Concrete slabs over trench to drains with less than 600mm cover, for drains under pedestrian traffic areas, 100mm reinforced concrete bridging over trench to drains with less than 900mm cover.

Access fittings, inspection chambers, manholes and covers to civil engineers and local Water Authority design and specification.

Manhole and inspection chamber covers within paved areas to be recessed to receive pavement surface.

**Internal Drainage:**  
100mm diameter soil and vent pipe with collection manifold in uPVC to terminate with vent a minimum of 900mm above any external opening within 3,000mm, or proprietary air admittance valve. 100mm diameter wastes to W.C's, 40mm diameter wastes to baths, sinks, washing machines and showers and 32mm diameter wastes to basins. All baths, showers and W.C's to be fitted with 50mm deep seal traps. All other appliances to be fitted with 75mm deep seal trap. Access plugs to be provided at all 90o changes in direction.

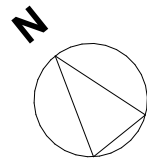
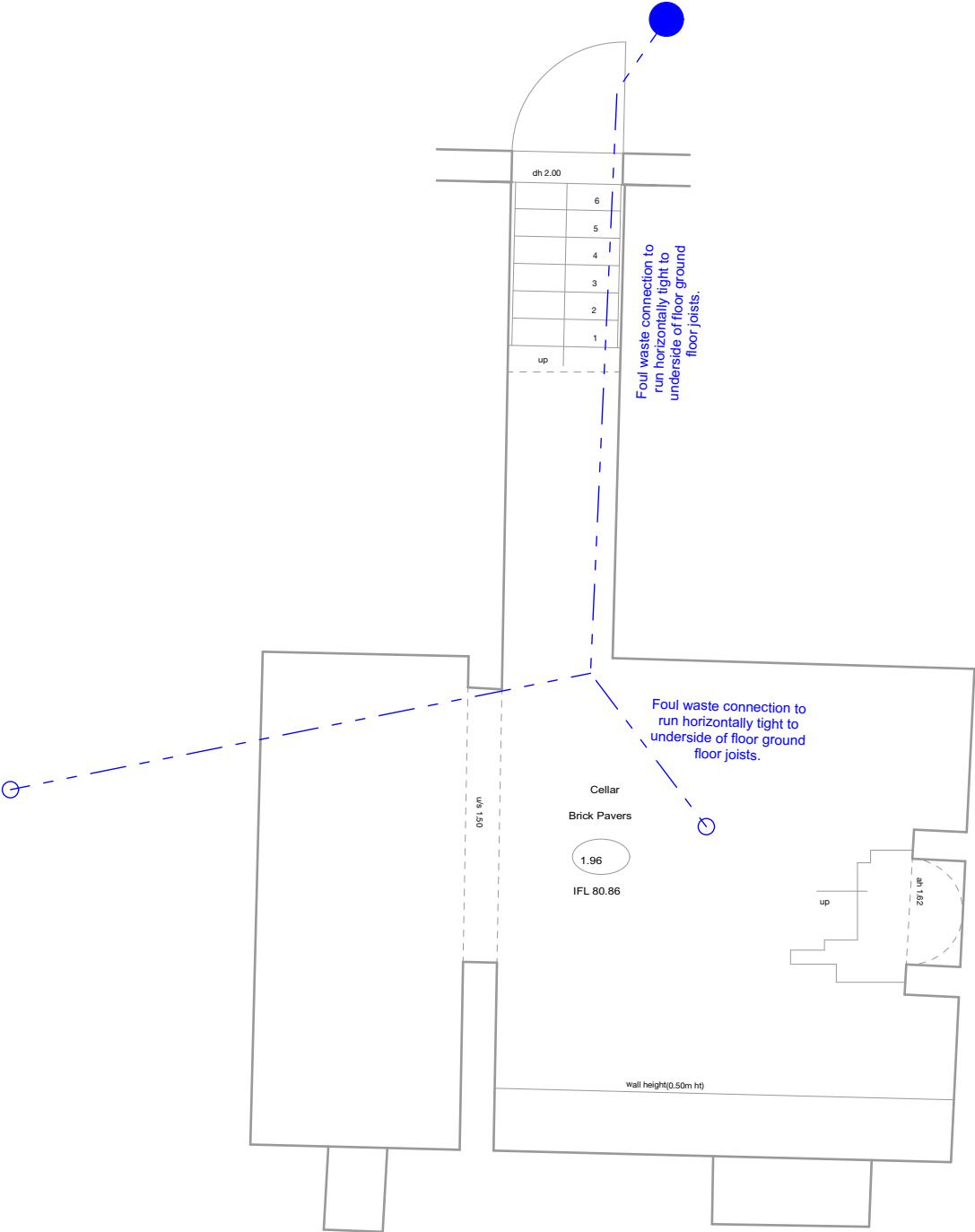

## Basement

Scale: 1:50

Scale (m)

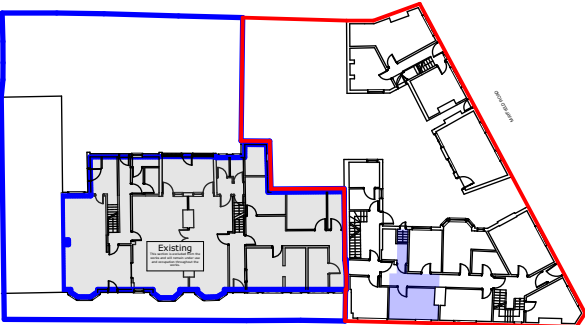

## Floor Plan Layout - Key

Scale: NTS

**Disclaimer:** brp architects ltd. accept no responsibility for work not undertaken fully in accordance with the contents of this drawing and related specifications. This document and its design content is copyright protected ©. It shall be read in conjunction with all other associated project information including models, specifications, schedules and related consultants documents. Do not scale from documents. All scales noted correct at original paper size. All dimensions to be checked on site. Immediately report any discrepancies, errors or omissions on this document to the originator. If in doubt ask.  
**Source File:**  
A77-6 26 Action Homeless Leicester 20231017 Onwards.pln

Rev	Date	Drawn	Note
-----	------	-------	------



Client  
Action Homeless

Project Title  
Proposed Alterations  
Mayfield House, St James Terrace /  
Mayfield Road,  
Leicester

Drawing Title  
Basement Floor Plan Proposed

Drawing Status  
Tender

Scaled to: 1:50	Original Paper Size A3
Drawn By KRJ	Checked By (If file copy only) Date 03.12.2024

Document Reference:  
**A77-BRP-00-GF-DR-A-2015-T01**